

"A12BW" SERIES COSTECH FANS

Description: **Axial fan a.c. 120X120x38mm**

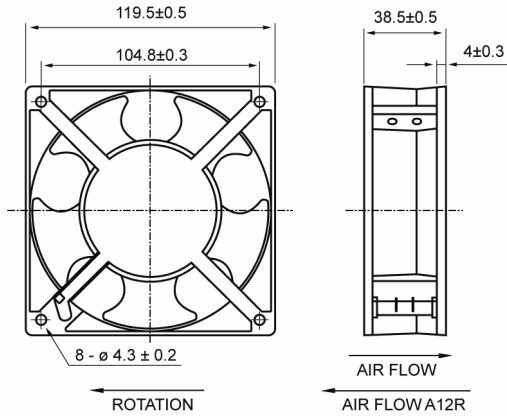

Casing material: die-casting aluminium painted black
Impeller material: black thermoplastic UL 94V-0
Protection degree: IP20, according to EN 60529 standard
Insulation class: A
Fixing system: 4 holes Ø4.3 mm
Motor protection: impedance
Storage temperature: from -40°C to +70°C
Rated temperature range: from -10°C to +60°C
Lifetime L10 at 40°C: 30.000 h
Electrical connection: flat terminals
Approvals: UL E223195; VDE 40009963
Weight: 0.550 kg

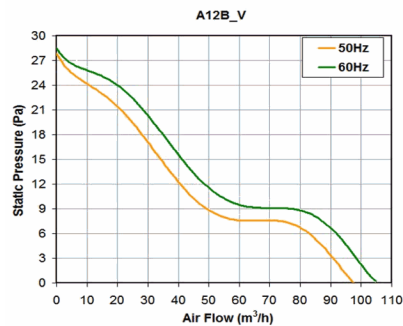
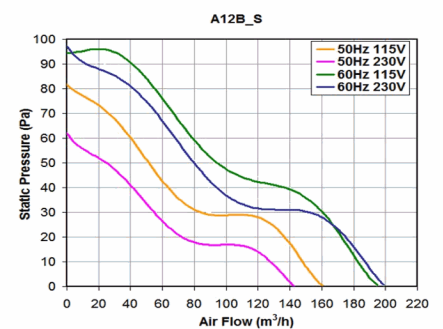
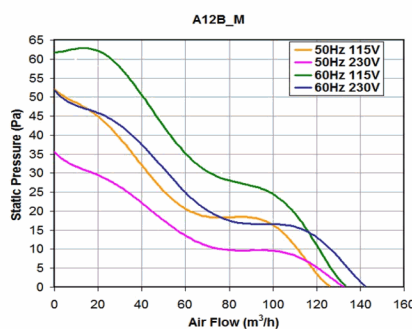
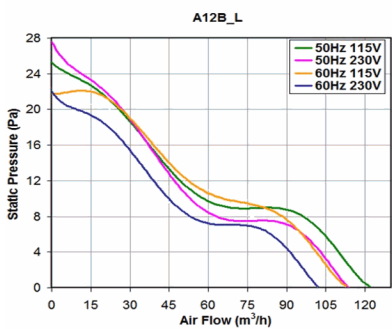
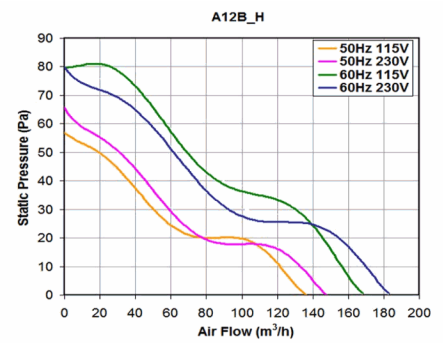
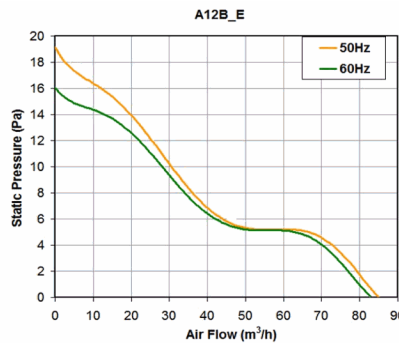
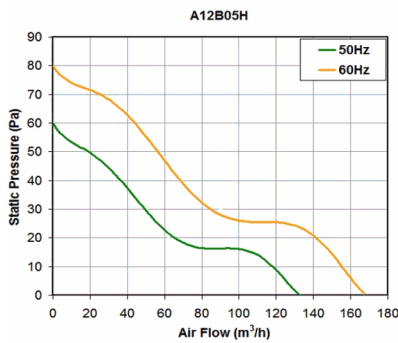

All specifications, data and drawing are subject to change without notice. Please refer to our terms of sales including our warranty and limited liabilities clauses.

| Model | Bearing | Voltage | Frequency | Rated Current | Rated Power | Max Air Flow** | Static Pressure | Noise | RPM | Approvals |
|--------------|---------|------------|-----------|---------------|-------------|----------------|-----------------|-----------|-------------|----------------|
| | | (V) | (Hz) | (A) | (W) | (m3/h) | (Pa) | [db(A)] | (rpm) | |
| A12B12HTBW00 | Ball | 115 V a.c. | 50/60 | 0.210/0.180 | 20/18 | 148/182 | 65/80 | 46.0/49.0 | 2,750/3,050 | CE; cURus; VDE |
| A12B12HTSW00 | Sleeve | 115 V a.c. | 50/60 | 0.210/0.180 | 20/18 | 138/178 | 55/75 | 44.0/48.0 | 2,750/3,050 | CE; cURus; VDE |
| A12B12LTBW00 | Ball | 115 V a.c. | 50/60 | 0.120/0.130 | 11/11 | 133/122 | 35/32 | 42.0/40.0 | 2,300/2,100 | CE; cURus; VDE |
| A12B12LTSW00 | Sleeve | 115 V a.c. | 50/60 | 0.130/0.110 | 11/11 | 115/104 | 35/20 | 41.0/37.0 | 2,200/1,800 | CE; cURus; VDE |
| A12B12MTBW00 | Ball | 115 V a.c. | 50/60 | 0.170/0.160 | 16/15 | 136/143 | 52/62 | 44.0/46.0 | 2,500/2,700 | CE; cURus; VDE |
| A12B12MTSW00 | Sleeve | 115 V a.c. | 50/60 | 0.170/0.160 | 16/15 | 129/141 | 50/52 | 44.0/46.0 | 2,400/2,600 | CE; cURus; VDE |
| A12B12STBW00 | Ball | 115 V a.c. | 50/60 | 0.260/0.240 | 22/20 | 165/182 | 75/95 | 48.0/50.0 | 2,850/3,150 | CE; cURus; VDE |
| A12B12STSW00 | Sleeve | 115 V a.c. | 50/60 | 0.260/0.240 | 22/23.8 | 165/182 | 62/95 | 47.0/50.0 | 2,700/3,100 | CE; cURus; VDE |
| A12B12VTBW00 | Ball | 115 V a.c. | 50/60 | 0.096/0.089 | 8.1/7.5 | 98/105 | 28/28 | 37.0/38.0 | 1,850/1,900 | CE |
| A12B23ETBW00 | Ball | 230 V a.c. | 50/60 | 0.035/0.035 | 6.5/6.0 | 83/82 | 16/16 | 29.0/28.0 | 1,500/1,450 | CE |
| A12B23ETSW00 | Sleeve | 230 V a.c. | 50/60 | 0.035/0.035 | 6.5/6.0 | 83/82 | 16/16 | 29.0/28.0 | 1,500/1,450 | CE |
| A12B23HTBW00 | Ball | 230 V a.c. | 50/60 | 0.130/0.110 | 20/19 | 139/182 | 60/80 | 46.0/49.0 | 2,750/3,050 | CE; cURus; VDE |
| A12B23HTSW00 | Sleeve | 230 V a.c. | 50/60 | 0.130/0.110 | 20/19 | 138/178 | 55/75 | 44.0/48.0 | 2,55/2,900 | CE; cURus; VDE |
| A12B23LTBW00 | Ball | 230 V a.c. | 50/60 | 0.050/0.060 | 11/10 | 114/102 | 27/22 | 44.0/42.0 | 2,200/1,800 | CE; cURus; VDE |
| A12B23LTSW00 | Sleeve | 230 V a.c. | 50/60 | 0.050/0.060 | 11/10 | 115/104 | 35/20 | 41.0/37.0 | 2,200/1,800 | CE; cURus; VDE |
| A12B23MTBW00 | Ball | 230 V a.c. | 50/60 | 0.090/0.080 | 16/15 | 133/143 | 47/57 | 43.0/45.0 | 2,400/2,600 | CE; cURus; VDE |
| A12B23MTSW00 | Sleeve | 230 V a.c. | 50/60 | 0.090/0.080 | 16/15 | 129/141 | 50/52 | 44.0/46.0 | 2,300/2,500 | CE; cURus; VDE |
| A12B23STBW00 | Ball | 230 V a.c. | 50/60 | 0.140/0.120 | 22/21 | 143/199 | 62/97 | 47.0/50.0 | 2,700/3,100 | CE; cURus; VDE |
| A12B23STSW00 | Sleeve | 230 V a.c. | 50/60 | 0.140/0.120 | 22/21 | 141/182 | 62/95 | 47.0/50.0 | 2,600/3,100 | CE; cURus; VDE |
| A12B23VTBW00 | Ball | 230 V a.c. | 50/60 | 0.050/0.050 | 10/10 | 98/105 | 27/27 | 37.0/38.0 | 1,850/1,900 | CE; VDE |
| A12B05HTBW00 | Ball | 24 V a.c. | 50/60 | 0.80/0.77 | 14/14 | 129/142 | 55/40 | 45.0/48.0 | 2,550/2,800 | CE |
| A12B05HTSW00 | Sleeve | 24 V a.c. | 50/60 | 0.75/0.73 | 13.2/13.2 | 147/142 | 55/50 | 46.0/45.0 | 2,530/2,430 | CE |
| A12B05LTBW00 | Ball | 24 V a.c. | 50/60 | 0.71/0.65 | 13/12 | 105/115 | 30/30 | 38.0/40.0 | 1,920/2,090 | CE |

data with uncertainty of 15%