

Piston rod cylinders ▶ Standard cylinders

ISO 1552, Series PRA
Accessories

Bearing block, Series AB7

▶ Cylinder mounting in accordance with ISO 1552



00105160

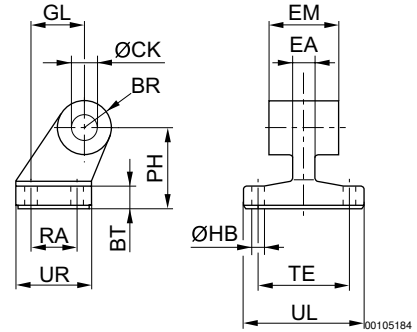

Part No.	Piston Ø	BR	BT	Ø CK H9	Ø HB H13	EM	GL JS14	EA 1)	PH JS15	RA JS14	TE JS14
1825805275	32	10	8	10	6.6	26 -0,2/-0,6	21	10	32	18	38
1825805276	40	11	10	12	6.6	28 -0,2/-0,6	24	12	36	22	41
1825805277	50	13	12	12	9	32 -0,2/-0,6	33	16	45	30	50
1825805278	63	15	12	16	9	40 -0,2/-0,6	37	16	50	35	52
1825805279	80	15	14	16	11	50 -0,2/-0,6	47	20	63	40	66
1825805280	100	19	15	20	11	60 -0,2/-0,6	55	20	71	50	76
1825805281	125	22,5	20	25	14	70 -0,5/-1,5	70	30	90	60	94

Part No.	UL 1)	UR 1)									
1825805275	51	31									
1825805276	54	35									
1825805277	65	45									
1825805278	67	50									
1825805279	86	60									
1825805280	96	70									
1825805281	124	90									

1) Max.
Material: Nodular graphite iron
Surface: galvanized